

1

**GB**

**3 Flute End Mills - Square End**  
**Micrograin Solid Carbide**  
30° Right Hand Spiral - Right Hand Cutting  
- Center Cutting

**ES**

**Fresas de 3 labios - Punta plana**  
**Metal duro con micrograno**  
Hélice a derecha 30° - Corte a derecha  
- Corte al centro

**FR**

**Fraises 3 dents - Bout plat**  
**Carbure monobloc, micrograin**  
Hélice à droite, 30° - Coupe à droite  
- Coupe au centre

**PT**

**Fresas de topo de 3 navalhas/cortes**  
- Topo direito/reto  
**Metal duro-microgrão**  
Espiral de 30° à direita - Corte à direita  
- Corte central

**IT**

**Frese frontali a 3 tagli - Testa piana**  
**Micrograna**  
Elica destra a 30° - Taglio destrorso  
- Taglio al centro

**DE**

**Schaftfräser, 3 Schneiden**  
- Flachstirn  
**Vollhartmetall, Feinstkorn**  
30° Rechtsdrall - Rechtsschneidend  
- Zentrumschnitt

ød <sub>1</sub> mm	ød <sub>2</sub> mm	l <sub>1</sub> mm	l <sub>2</sub> mm	EDP No.	Ti-NAMITE EDP No.	Ti-NAMITE-C EDP No.	Ti-NAMITE-A EDP No.
1	3	38	4	40505	48756	48778	48799
1,5	3	38	4,5	40509	48757	48779	48800
2	3	38	6,3	40513	48758	48780	48801
2,5	3	38	9,5	40517	48759	48781	48802
3	3	38	12	40521	48760	48782	48803
3,5	4	50	12	40525	48761	48783	48804
4	4	50	14	40529	48762	48784	48805
4,5	6	50	16	40533	48763	48785	48806
5	6	50	16	40537	48764	48786	48807
6	6	50	19	40541	48765	48787	48808
7	8	63	19	40545	48766	48788	48809
8	8	63	20	40549	48767	48789	48810
9	10	75	22	40553	48768	48790	48811
10	10	75	22	40557	48769	48791	48812
11	12	75	25	40561	48770	48792	48813
12	12	75	25	40565	48771	48793	48814
14	14	89	32	40569	48772	48794	48815
16	16	89	32	40573	48773	48795	48816
18	18	100	38	40577	48774	48796	48817
20	20	100	38	40581	48775	48797	48818
25	25	100	38	40585	48776	48798	48819

**TOLERANCES**

ød<sub>1</sub> = +0,000 - 0,05  
ød<sub>2</sub> = +0,000 - 0,01

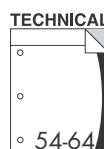
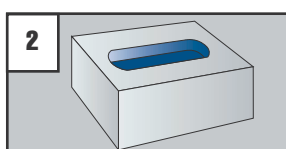
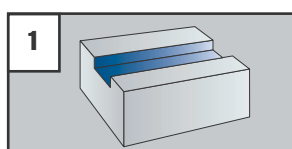

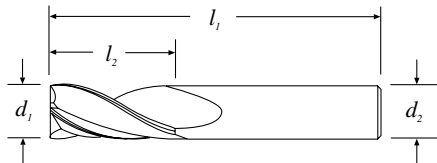

Cutting Diameter $d_1$	Length of Cut $l_2$	Overall Length $l_1$	Shank Diameter $d_2$	Uncoated	Ti-NAMITE (TiN)	Ti-NAMITE-C (TiCN)	Ti-NAMITE-A (AlTiN)
				EDP No.	EDP No.	EDP No.	EDP No.
1/64	1/32	1-1/2	1/8	30501	39701	30771	30811
1/32	5/64	1-1/2	1/8	30503	39703	30772	30812
3/64	7/64	1-1/2	1/8	30505	39705	30773	30813
1/16	3/16	1-1/2	1/8	30507	39707	30774	30814
5/64	3/16	1-1/2	1/8	30509	39709	30775	30815
3/32	9/32	1-1/2	1/8	30511	39711	30776	30816
7/64	3/8	1-1/2	1/8	30513	39713	30777	30817
1/8	3/8	1-1/2	1/8	30577	39777	30809	30849
1/8	1/2	1-1/2	1/8	30515	39715	30778	30818
9/64	1/2	2	3/16	30517	39717	30779	30819
5/32	1/2	2	3/16	30519	39719	30780	30820
11/64	5/8	2	3/16	30521	39721	30781	30821
3/16	5/8	2	3/16	30523	39723	30782	30822
13/64	5/8	2-1/2	1/4	30525	39725	30783	30823
7/32	5/8	2-1/2	1/4	30527	39727	30784	30824
15/64	3/4	2-1/2	1/4	30529	39729	30785	30825
1/4	3/4	2-1/2	1/4	30531	39731	30786	30826
17/64	3/4	2-1/2	5/16	30533	39733	30787	30827
9/32	3/4	2-1/2	5/16	30535	39735	30788	30828
19/64	13/16	2-1/2	5/16	30537	39737	30789	30829
5/16	13/16	2-1/2	5/16	30539	39739	30790	30830
21/64	1	2-1/2	3/8	30541	39741	30791	30831
11/32	1	2-1/2	3/8	30543	39743	30792	30832
23/64	1	2-1/2	3/8	30545	39745	30793	30833
3/8	1	2-1/2	3/8	30547	39747	30794	30834
25/64	1	2-3/4	7/16	30549	39749	30795	30835
13/32	1	2-3/4	7/16	30551	39751	30796	30836
27/64	1	2-3/4	7/16	30553	39753	30797	30837
7/16	1	2-3/4	7/16	30555	39755	30798	30838
29/64	1	3	1/2	30557	39757	30799	30839
15/32	1	3	1/2	30559	39759	30800	30840
31/64	1	3	1/2	30561	39761	30801	30841
1/2	1	3	1/2	30563	39763	30802	30842
9/16	1-1/8	3-1/2	9/16	30565	39765	30803	30843
5/8	1-1/4	3-1/2	5/8	30567	39767	30804	30844
11/16	1-3/8	4	3/4	30569	39769	30805	30845
3/4	1-1/2	4	3/4	30571	39771	30806	30846
7/8	1-1/2	4	7/8	30573	39773	30807	30847
1	1-1/2	4	1	30575	39775	30808	30848

#### TOLERANCES

$d_1 = +.000 - .002$   
 $d_2 = -.0001 - .0004$

#### E

##### Series 5

**3 Flute End Mills - Square End  
Micrograin Solid Carbide**

30° Right Hand Spiral - Right Hand Cutting  
- Center Cutting

#### ES

##### Serie 5

**Fresas de 3 filos - Punta plana  
Carburo sólido con micrograno**

Hélice a derecha 30° - Corte a derecha  
- Corte al centro

#### FR

##### Série 5

**Fraises 3 dents - Bout plat  
Carbure monobloc, micrograin**

Hélice à droite, 30° - Coupe à droite  
- Coupe au centre

TECHNICAL

